User Guide

Nokia 515 Dual SIM
RM-952

NOKIA

User Guide

Nokia 515 Dual SIM

Contents

Safety	3	Take a photo	20
Get started	4	Take a self-portrait	20
Keys and parts	4	Take a panorama photo	21
Insert a SIM card and battery	4	Send a photo or video	21
Insert a second SIM card	6	Maps & navigation	22
Insert a memory card	6	Find nearby places	22
Charge the battery	7	Internet	23
Set which SIM card to use	8	Browse the web	23
Copy content from your old phone	8	Add a website to your favourites	23
Basics	10	Entertainment	24
Explore your phone	10	Listen to the radio	24
Display indicators	11	Play a song	24
Prolong battery life	11	Office	26
Personalise your home screen	12	Add a calendar entry	26
Change your ringtone	12	Change the time and date	26
Set a song as your ringtone	12	Set an alarm	26
Nokia Store	13	Phone management & connectivity	27
Write text	13	Share your content using Slam	27
People & messaging	14	Copy content between your phone and a computer	27
Make or answer a call	14	Back up content to a memory card	28
Save a name and phone number	14	Update your phone software	28
Add social info to contacts	14	Access codes	28
Send a message	15	Product and safety information	30
Check your voice mail	15		
Mail for Exchange	16		
Set up your mail account	17		
Send a mail	17		
Get social	18		
Chat with your friends	18		
Camera	20		

Safety

Read these simple guidelines. Not following them may be dangerous or illegal. For further info, read the complete user guide.



SWITCH OFF IN RESTRICTED AREAS

Switch the device off when mobile phone use is not allowed or when it may cause interference or danger, for example, in aircraft, in hospitals or near medical equipment, fuel, chemicals, or blasting areas. Obey all instructions in restricted areas.



ROAD SAFETY COMES FIRST

Obey all local laws. Always keep your hands free to operate the vehicle while driving. Your first consideration while driving should be road safety.



INTERFERENCE

All wireless devices may be susceptible to interference, which could affect performance.



QUALIFIED SERVICE

Only qualified personnel may install or repair this product.



BATTERIES, CHARGERS, AND OTHER ACCESSORIES

Use only batteries, chargers, and other accessories approved by Nokia for use with this device. Do not connect incompatible products.



KEEP YOUR DEVICE DRY

Your device is not water-resistant. Keep it dry.



GLASS PARTS

The device screen is made of glass. This glass can break if the device is dropped on a hard surface or receives a substantial impact. If the glass breaks, do not touch the glass parts of the device or attempt to remove the broken glass from the device. Stop using the device until the glass is replaced by qualified service personnel.



PROTECT YOUR HEARING

To prevent possible hearing damage, do not listen at high volume levels for long periods. Exercise caution when holding your device near your ear while the loudspeaker is in use.



SAR

This device meets RF exposure guidelines when used either in the normal use position against the ear or when positioned at least 1.5 centimetres (5/8 inch) away from the body. The specific maximum SAR values can be found in the Certification Information (SAR) section of this user guide. For more info, go to www.sar-tick.com.

When a carry case, belt clip or other form of device holder is used for body-worn operation, it should not contain metal and should provide at least the above-stated separation distance from the body. Note that mobile devices may be transmitting even if you are not making a voice call.

Get started

Get to grips with the basics, and have your phone up and running in no time.

Keys and parts

Explore the keys and parts of your new phone.

- 1 Micro-USB connector
- 2 Headset connector (3.5 mm AHJ)
- 3 Volume keys
- 4 Scroll key
- 5 End/Power key
- 6 Back cover release hole
- 7 Microphone
- 8 Call key
- 9 Selection keys
- 10 Earpiece
- 11 Camera flash
- 12 Camera lens. Before using the camera, remove the protective tape from the lens.
- 13 Back cover opening tool. If you lose the tool, you can also use a paper clip.
- 14 Antenna area
- 15 Loudspeaker

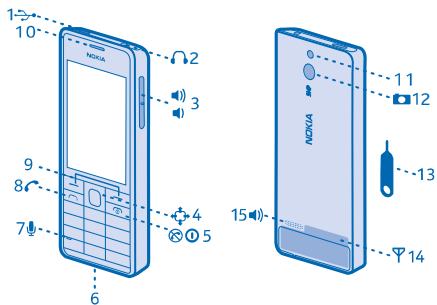

★ **Tip:** Lock the keys when not using your phone. Select **Menu**, and press *. To unlock, select **Unlock**, and press *.

Your phone uses S40 software.

Avoid touching the antenna area while the antenna is in use. Contact with antennas affects the communication quality and may reduce battery life due to higher power level during operation.

Do not connect products that create an output signal, as this may damage the device. Do not connect any voltage source to the audio connector. If you connect an external device or headset, other than those approved for use with this device, to the audio connector, pay special attention to volume levels.

The images in this guide may differ from your device screen.

Insert a SIM card and battery

Learn how to insert a SIM card and the battery.

The SIM1 holder can be used for both 3G and 2G SIMs. The SIM2 slot can only be used for 2G SIMs.

1. Push the tool into the hole until the cover is released. Remove the back cover.

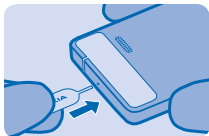

2. If the battery is in the phone, lift it out.

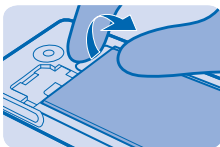

3. Push the SIM in with the contact area face down.

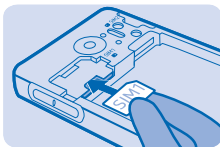

4. Line up the battery contacts, and put the battery in.

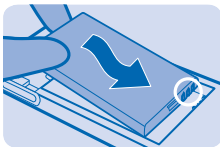

5. Press the back cover down until it locks into place. To switch the phone on, press and hold the power key  until the phone vibrates.

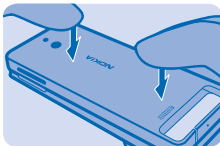

! **Note:** Switch the device off and disconnect the charger and any other device before removing any covers. Avoid touching electronic components while changing any covers. Always store and use the device with any covers attached.

! **Important:** To prevent damage to the SIM card, always remove the battery before you insert or remove the card. Only applies to SIM1.

- Important:** This device is designed to be used with a mini-UICC SIM card, also known as a micro-SIM card only. A micro-SIM card is smaller than the standard SIM card. Use of incompatible SIM cards, or use of SIM card adapters, may damage the card or the device, and may corrupt data stored on the card.

Insert a second SIM card

You can easily add a second SIM card (SIM2) without removing the battery.

1. Push the tool into the hole until the cover is released. Remove the back cover.

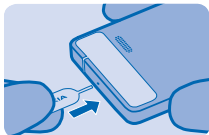

2. Push the SIM in with the contact area face down until it locks into place. The SIM2 slot can only be used for 2G SIMs.

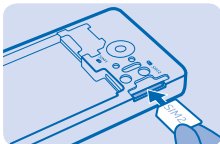

3. To remove the SIM, push the card in until it's released, then pull it out.

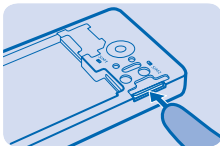

If you only have one SIM card, put the card into the SIM1 card holder. Some features and services may only be available when using the SIM card in the SIM1 card holder. If there is a SIM card only in the SIM2 card holder, you can only make emergency calls.

Both SIM cards are available at the same time when the device is not being used, but while one SIM card is active, for example, making a call, the other is unavailable.

Insert a memory card

Learn how to insert a memory card into your phone.

Use only compatible memory cards approved for use with this device. Incompatible cards may damage the card and the device and corrupt data stored on the card.



1. Push the tool into the hole until the cover is released. Remove the back cover, and lift out the battery.

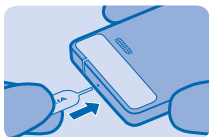

2. Slide the memory card into place with the contact area face down.

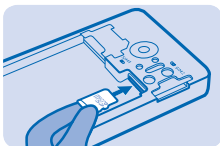

3. To remove the card, pull it out.

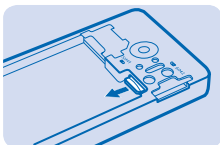

- !** **Important:** Do not remove the memory card when an app is using it. Doing so may damage the memory card and the device and corrupt data stored on the card.

Charge the battery

Your battery has been partially charged at the factory, but you may need to recharge it before you can use your phone.

1. Plug the charger into a wall outlet.

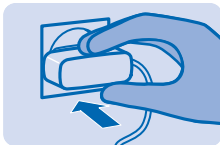

2. Connect the charger to the phone. When done, unplug the charger from the phone, then from the wall outlet.

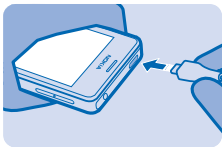

If the battery is completely discharged, it may take several minutes before the charging indicator is displayed or before any calls can be made.

- ★ **Tip:** You can use USB charging when a wall outlet is not available. Data can be transferred while charging the device. The efficiency of USB charging power varies significantly, and it may take a long time for charging to start and the device to start functioning.

Set which SIM card to use



You can set the default SIM card to use to make a call, send a message, or connect to the internet. If you name your SIMs, you can see at a glance which is, for example, for work and which is for personal use.

1. Select **Menu > SIM mgr..**
2. To decide every time which SIM to use, select **Ask every time.**
3. Select **SIM1** or **SIM2** to set which SIM to use for which connection.

Rename your SIM card

Select **Options > Rename.**

Copy content from your old phone



Easily get your contacts, calendar entries, and other stuff to your new phone.

1. Switch Bluetooth on in both phones. To switch Bluetooth on on your new phone, select **Menu > Settings > Connectivity > Bluetooth.**
2. On your new phone, select **Menu > Settings > Sync & backup > Copy from dev..**
3. Select what you want to copy, then select **Done.**
4. Choose your old phone from the list of found devices.

5. If asked, create a one-time passcode (such as 123), and select **OK**.
 6. Check that the codes match on both phones.
 7. Follow the instructions shown on both phones.
- ★ **Tip:** To quickly copy contacts from a compatible phone, select **Menu > Apps > My apps > Transfer**.

Basics

Learn how to get the most out of your new phone.

Explore your phone

Explore your phone with a simple key press.

1. To see the apps and features of your phone, press **Menu**.

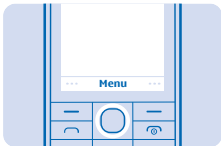

2. To go to an app or feature, press the scroll key up, down, left, or right.

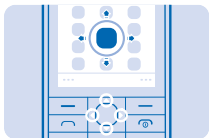

3. To open the app or select the feature, press **Select**.



4. To go back to the previous view, press **Back**.



5. To go back to the home screen, press .

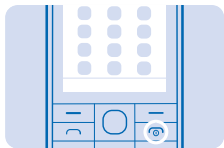

Display indicators

The display indicators on your phone tell you the current time, battery and signal strength, and much more.

- You have unread messages sent to SIM1, SIM2, or both.
- You have unsent or failed messages from SIM1, SIM2, or both.
- The keys are locked.
- An alarm is set.
- Bluetooth is on.
- The phone is connected to a GSM network.
- All incoming calls to SIM1, SIM2, or both are forwarded to another number.
- The phone is connected to a headset.
- The phone is connected to a device, such as a PC, with a USB cable.

The type of mobile network you're currently connected to may be shown with a single letter, a combination of letters, or a combination of letters and numbers. For example, **2G**, depending on your network service provider.

The icons may vary depending on your region or network service provider.

Prolong battery life

Get the most out of your phone while getting the battery life you need. There are steps you can take to save power on your phone.

- Always charge the battery fully.
- Mute unnecessary sounds, such as key press sounds.
- Use wired headphones, rather than the loudspeaker.

To save power, you can:

Lower the backlight brightness

Select **Menu > Settings > Display > Backlight**, and change the setting for **Backlight intensity**.

Set the backlight to switch off after a short time

Select **Menu > Settings > Display > Backlight**, and change the setting for **Backlight time-out**.

-
- Use network connections selectively
- Switch Bluetooth on only when needed.
 - If you're listening to music or otherwise using your phone, but don't want to make or receive calls, switch flight mode on. Select **Menu > Settings > Profiles > Flight > Activate**.
-

Personalise your home screen

Want to open your favourite apps straight from the home screen? You can add, remove, and rearrange items on your home screen.

1. Scroll down on the home screen, and select **Options > Personalise view**.
2. Select a bar and an item, such as **Notifications**.
3. Select **Done > Yes**.

★ **Tip:** To add more apps, scroll to the shortcut bar on the home screen, and select **Options > Change shortcut**.

Change your ringtone



Set a ringtone for your phone. You can set a different ringtone for each SIM card.

1. Select **Menu > Settings > Tones**, and scroll to the ringtone options. If asked, select a SIM card.
2. Use the scroll key to select **Open Files**.
3. Select **Tones > Ringtones**.
4. Select the ringtone.

★ **Tip:** To switch between the silent and normal profile, press and hold #.

Set a song as your ringtone

You can set a song from the music player as your ringtone.

1. When setting a ringtone, scroll left to select **Open Files**, and select the song.
2. You can mark a section of a song to use as a ringtone. Select **Yes**.
3. To move the start point ▼, scroll left or right. To move the end point ▲ in the same way, scroll down. When you're ready, select **Done**.
4. Select **Save**.

The edited ringtone doesn't replace the original ringtone or sound clip. Preset ringtones can't be edited, and not all formats of ringtones are supported.

Nokia Store



Download mobile games, apps, themes, wallpapers, and ringtones to your phone from Nokia Store.

Select **Menu > Store**.

Many items are free of charge; some you need to pay for with your credit card or on your phone bill.

The availability of payment methods depends on your country of residence and your network service provider.

To learn more about Nokia Store, go to store.ovi.com.

Write text

Want to write a note or maybe use more than one language in your message? Writing with the keypad is easy and fun.

Press a key repeatedly until the letter is shown.

Type in a special character or punctuation mark

Press *****, and select the character.

Switch between character cases and text input methods

Press **#**. This may not be available in all languages.

Type in a number

Press and hold **#**, and select **Number mode**. To go back to letter mode, press and hold **#**.

Switch predictive text on or off

Select **Options > Prediction**, and select **On** or **Off**. Not all languages are supported.

Change the writing language

Select **Options > Writing language**.

People & messaging

Contact your friends and family, and share your files, such as photos, using your phone. Stay tuned with the latest updates to your social networking services even when on the go.

Make or answer a call

Learn how to make or answer a call with your new phone.

1. On the home screen, type in the phone number.
To type in the + character, used for international calls, press * twice.
2. Press . If asked, select which SIM to use.
3. To end the call, press .

When someone calls you, press to answer.

★ **Tip:** Is your friend's voice too loud or quiet? Press the volume keys to change the volume.

⚠ **Warning:** When the flight profile is activated, you cannot make or receive any calls, including emergency calls, or use other features that require network coverage. To make a call, switch to another profile.

Call last dialed number

On the home screen, press , select the number, and press .

View your missed calls

On the home screen, press **View**. To call back, select the number, and press .

★ **Tip:** To view missed calls later, select **Menu > Contacts > Log > Missed calls**. Missed and received calls are logged only if supported by the network, and the phone is switched on and within the network service area.

Save a name and phone number



Add new contacts to your phone.

1. Select **Menu > Contacts**.
2. Select **Add new**. If asked, select where to save the contact.
3. Type in the phone number, and select **OK**.
4. Write the name, and select **Save**.

Add social info to contacts

Sign in to social networking services to add your friends' info to your phone contacts list.

1. Select **Menu > Contacts**.
2. Select **Names > Options > Social accounts**.
3. Select whether you want to import all or only those that are already in your contacts list. Info from the account shows up in your contacts list.

Send a message



With text and multimedia messages, you can quickly contact your friends and family.

1. Select **Menu > Messaging**.
2. Select **Create message**.
3. Write your message.
4. To add an attachment, such as a photo or video, select **Options > Insert object**.
5. To add a contact as a recipient, select **Send to > Contacts**. To type in a number, select **Number or mail**.
6. Select **Send**. If asked, select which SIM to use.

If the item you insert in a multimedia message is too large for the network, the device may automatically reduce the size.

Only compatible devices can receive and show multimedia messages. Messages may look different in different devices.

You can send text messages that are longer than the character limit for a single message. Longer messages are sent as two or more messages. Your service provider may charge accordingly. Characters with accents, other marks, or some language options, take more space, and limit the number of characters that can be sent in a single message.

Check your voice mail



Did you let your calls go to voice mail when you couldn't answer? Listen to the messages people have left you at a convenient time.

To use voice mail, you may need to subscribe to the service. For more info, contact your network service provider.

Before using your voice mailbox, get your voice mailbox number from your network service provider. Check your order confirmation or your network service provider's support website.

To set up your voicemail, select **Menu > Messaging > More > Voicemails > Voice call messages > Voice mailbox no.**, and type in your voice mailbox number.

1. To check your voice mail when you just missed a call, select **View** on the home screen.

2. Select **Options > Call sender**.

★ **Tip:** To quickly call your voice mail, press and hold **1** on the home screen.

Listen to your voice mail later

Select **Menu > Messaging > More > Voicemails > Voice call messages > Listen to voicemails**.

Mail for Exchange

Would you like to have your work mail, contacts, and calendar at hand, whether you are sitting by your computer or on the go with your phone? You can sync the important content between your phone and a Microsoft Exchange server.

Mail for Exchange can be set up only if your company has a Microsoft Exchange server. In addition, your company IT administrator must have activated Microsoft Exchange ActiveSync for your account.

Before starting the setup, make sure you have the following:

- A corporate mail address
- Your Exchange server name (contact your company IT department)
- Your network domain name (contact your company IT department)
- Your office network password

Depending on the Exchange server configuration, you may need to type in additional info during the setup. If you don't know the correct info, contact your company IT department.

During the setup, you can define how often you want your phone to sync the content with the server. Only content defined when setting up the account is synced. To sync additional content, change the Mail for Exchange account settings.

With Mail for Exchange, it may be mandatory to use the lock code.

Use of the Mail for Exchange is limited to over-the-air synchronisation of PIM information between the Nokia device and the authorised Microsoft Exchange server.

This device is able to communicate with Microsoft Exchange ActiveSync enabled servers. The provision of this device to you does not grant you, and you do not receive, any rights under any Microsoft intellectual property with respect to any server software, or server device, that is accessed using this device or with respect to use of Microsoft Exchange ActiveSync apart from this device.

Set up your mail account



Do you use more than one mail address? You can have several mail accounts on your phone. You must be connected to the internet to set up a mail account, and to send and receive mail.

1. Select **Menu > Mail**.
2. Select a mail service, and sign in.

★ **Tip:** If you don't have a mail address, you can create a Nokia Mail account during setup.

You can add a Mail for Exchange account to your phone if you want to sync your work or other mail, including contacts and calendar, with your phone. Select **Menu > Mail Exch.** and a mail account, and type in the required details.

Add a mail account later

Select **Menu > Mail > Add account** and a mail service, and sign in.

Send a mail



Would you like to send a mail while on the go? With your phone, you can read and send mail, even when not sitting at your desk.

1. Select **Menu > Mail** and a mail account. If asked, select which SIM to use.
2. In the mailbox, select **Options > Compose new**.
3. To add a recipient from your contacts, select **Add**. You can also write the address. You can add more than one recipient.
4. Write the subject and your message.
5. To attach a file, such as a photo, select **Options > Attach**.
6. Select **Send**.

Reply to a mail

To reply to a mail, open the mail, and select **Options > Reply**.

Get social



Use the Notifications app to see what's happening with your friends.

Sign in to your social networking services.

1. Select **Menu > Apps**.
2. Select **My apps > Notifications**.

★ **Tip:** Add Notifications to your home screen to see the latest updates.

Switch notifications off

In the Notifications app, select **Options > Settings**, scroll left or right, and select **Save**.

Chat with your friends



Do you like chatting online with your friends? You can send instant messages with your phone when you're out on the town.

You must be connected to the internet to chat.

Before you can use chat, set up a chat service on your phone. You need a Nokia account to chat. Select **Menu > Chat > Chat**, and sign in. If asked, select which SIM to use.

If you don't have a chat account, you can sign in to Nokia Chat during setup.

If you have added friends to your chat contacts, they are automatically included in your contacts. You can also chat with others than just your chat contacts.

1. Select **Menu > Chat > Chat**. If asked, select which SIM to use.
2. Select an account, and sign in.
3. Select **Options > Chat with**.
4. Select a chat service, write the username, and select **Options > Send**.
5. Write your message in the text box, and select **Send**.

★ **Tip:** To quickly start a chat with a contact, select your contact in your list of friends and **Send**.

You can have several conversations going on at the same time. To switch between conversations, select one in **Conversations**.

Using services or downloading content may cause the transfer of large amounts of data, which may result in data costs.

Camera

Why carry a separate camera if your phone has all you need for capturing memories? With your phone camera, you can easily take photos or record videos.

Take a photo

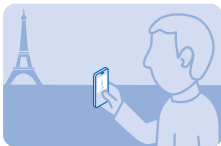

Capture the best moments with your phone camera.

1. To switch the camera on, select **Menu > Camera**.
2. To zoom in or out, use the volume keys.
3. To take the photo, select .

★ **Tip:** To record a video, scroll right, and select .

The photos are saved in **Menu > Photos**.

Keep a safe distance when using the flash. Do not use the flash on people or animals at close range. Do not cover the flash while taking a photo.



Switch the camera off

Select .

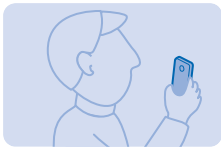
Take a self-portrait



It's easy to take a self-portrait with your phone camera.

1. To switch the camera on, select **Menu > Camera**.
2. Select  > .
3. Hold the phone with the camera facing you, and follow the instructions you hear. When ready, the phone takes the photo automatically.

Take a panorama photo



Want to take a photo of a beautiful landscape or skyline? Use panorama mode to take a spectacular photo.

1. To switch the camera on, select **Menu > Camera**.
2. Select **☰ > [Panorama]**.
3. To take the first photo, select **[Camera]**.
4. To take the next photo, move the phone slowly to the right until the indicator is in the middle of the screen.
5. When you have taken 4 photos, the phone saves the panorama photo automatically.

★ **Tip:** You can take a panorama photo with the phone in landscape or portrait position.

Send a photo or video

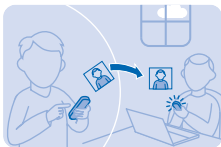

Send your best shots to your friends and family in a multimedia message or mail, or using Bluetooth.

1. Select **Menu > Photos**.
2. Go to the photo, and select **Options > Share** and how you want to send.

★ **Tip:** To send a video, select **Menu > Videos**, the video you want to send, and **Options > Share**.

Send several photos or videos at the same time

Go to the folder where the photos or videos are, and select **Options > Mark** and an option. To send, select **Options > Share marked** and how you want to send.

Maps & navigation

Explore what's out there and how to get there.

Find nearby places



Explore the world around you – with Nokia Nearby, you can check for nearby places, such as restaurants and shopping centres.

1. Select **Menu > Apps > My apps > Nokia Nearby**.

2. To see a list of certain types of places, such as restaurants, select the category. If you don't see the category you want in the main view, to see more categories, select **More**.

★ **Tip:** To see the place on a map, select the place, and in the place details view, select **MAP**.

3. To search for a place, in the main view, write the place name in the search box.

★ **Tip:** You can save a place, so you can easily find it later. Select the place and ❤️ > **SAVE**. To see your saved places, in the Nokia Nearby main view, select **More > ❤️**.

Using services or downloading content may cause the transfer of large amounts of data, which may result in data costs.

This service may not be available in all countries or regions, and may be provided only in selected languages. The service may be network dependent. For more info, contact your network service provider.

Contents of digital maps may sometimes be inaccurate and incomplete. Never rely solely on the content or the service for essential communications, such as in emergencies.

! **Note:** Before sharing your location, always consider carefully with whom you are sharing. Check the privacy settings of the social networking service you are using, as you might share your location with a large group of people.

Internet

Learn how to browse the web.

Browse the web



Catch up on the news, and visit your favourite websites on the go.

1. Select **Menu > Internet**.
2. Select the address bar.
3. Write a web address.

★ **Tip:** To search the internet, write a search word in the address bar. If asked, select your default search engine.

Zoom in

Select a section of the page.

★ **Tip:** To view the page in a single column of larger, readable text and pictures without having to zoom in, select **Options > Settings**, and switch **Column view** to **On**.

Add a website to your favourites



If you visit the same websites all the time, add them to your favourites, so you can easily access them.

1. Select **Menu > Internet**.
2. Go to a website.
3. Select **Options > Add to favourites**.

Go to a favourite website

Open the **Favourites** tab, and select a favourite.

Entertainment

Having a spare moment and in need of entertainment? Learn how to listen to the radio on your phone.

Listen to the radio



You can listen to FM radio stations using your phone – just select a station.

To listen to the radio, you need to connect a compatible headset to the device. The headset acts as an antenna.

Select **Menu > Radio**.

Close the radio

Press the end key.

Set the radio to play in the background

Select **Options > Play in background**.

Close the radio when it is playing in the background

Press and hold the end key.

Play a song



Play music stored in the phone memory or on the memory card.

1. Select **Menu > Music**.

2. Select a song. To pause or resume playing, select **||** or **▶**.

Skip to the beginning of the current song

Scroll left.

Skip to the previous song

Scroll left twice.

Skip to the next song

Scroll right.

Fast-forward or rewind

Press and hold the scroll key to the right or left.

Close the music player

Press the end key.

Set the music player to play in the background

Select **Options > Play in background**.

Close the music player when it is playing in the background

Press and hold the end key.

Office

Learn how to use the calendar to keep yourself organised.

Add a calendar entry

Need to remember an appointment? Add it to your calendar.

1. Select **Menu** > **Calendar**.
2. Select a date and **View** > **Add**.
3. Select an entry type.
4. Fill in the fields, and select **Save**.

★ **Tip:** To delete an entry, go to the entry, and select **Options** > **Delete**.

Change the time and date



You can set your phone clock manually.

Select **Menu** > **Settings** > **Date and time**.

Change the time zone when travelling

Select **Date & time settings** > **Time zone**; scroll left or right to select the time zone of your location, and select **Save**.

Set an alarm

You can use your phone as an alarm clock.

1. Select **Menu** > **Apps** > **Alarm clock**.
2. Select **Options** > **Add new alarm**, set the alarm time, and select **Save**.

★ **Tip:** To change an existing alarm, select the alarm, select **Open**, edit the alarm time, and select **Save**.

Repeat the alarm

Switch **Repeat**: to **On**, and select the days and **Done**.

Phone management & connectivity

Take care of your phone and its contents. Learn how to connect to accessories and networks, transfer files, create backups, lock your phone, and keep the software up to date.

Share your content using Slam



With Slam, sharing your content is now easier than ever.

1. Select **Menu > Settings > Connectivity > Bluetooth > On**.
2. Select **Phone visibility > Always visible** to make your phone visible to others.
3. Select, for example, a photo to share and **Options > Share > Via Slam**.
4. Move your phone close to the other phone.

Slam searches for the nearest phone, and sends the item to it.

Operating the device in hidden mode is a safer way to avoid malicious software. Do not accept Bluetooth connection requests from sources you do not trust. You can also switch the Bluetooth function off when you are not using it.

Copy content between your phone and a computer



You can use a USB cable (sold separately) to copy your photos and other content between your phone and a compatible computer.

1. Connect your phone to a computer with a compatible USB cable.
2. Select **Memory card**.
3. On your computer, open a file manager, such as Windows Explorer, and browse to your phone.
4. Drag and drop items between your phone and computer.

Back up content to a memory card

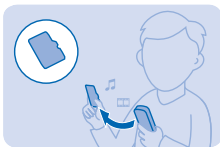

Want to make sure you won't lose any important files? You can back up your phone memory to a compatible memory card.

1. Select **Menu > Settings > Sync & backup**.
2. Select **Create backup**.
3. Select what you want to back up, then press **Done**.

Restore a backup

Select **Restore backup** and what you want to restore, then press **Done**.

Update your phone software

You can update your phone software wirelessly. You can also set your phone to automatically check for updates.

You can only update your software when using the SIM in the internal SIM holder.

1. Select **Menu > Settings > Phone > Device updates**.
2. To check if there is an update available and to download it, select **Downl. phone sw.**

The update may take several minutes. If you encounter problems, contact your network service provider.

After the update, go to www.nokia.com/support to get your new user guide.

Your network service provider may send updates over the air directly to your phone. For more info on this network service, contact your network service provider.

Using services or downloading content may cause the transfer of large amounts of data, which may result in data costs.

Before starting the update, connect a charger or make sure the device battery has enough power.

Warning: If you install a software update, you cannot use the device, even to make emergency calls, until the installation is completed and the device is restarted.

Access codes

Ever wondered what the different codes on your phone are for?

PIN or PIN2 code
(4-8 digits)

These protect your SIM card against unauthorised use or are required to access some features.

	<p>You can set your phone to ask for the PIN code when you switch it on.</p> <p>If you forget the codes or they aren't supplied with your card, contact your network service provider.</p> <p>If you type in the code incorrectly 3 times in a row, you need to unblock the code with the PUK or PUK2 code.</p>
PUK or PUK2	<p>These are required to unblock a PIN or PIN2 code.</p> <p>If not supplied with your SIM card, contact your network service provider.</p>
Security code (lock code, password)	<p>This helps you protect your phone against unauthorised use.</p> <p>You can set your phone to ask for the lock code that you define.</p> <p>Keep the code secret and in a safe place, separate from your phone.</p> <p>If you forget the code and your phone is locked, your phone will require service. Additional charges may apply, and all the personal data on your phone may be deleted.</p> <p>For more information, contact Nokia Care or your phone dealer.</p>
IMEI	<p>This is used to identify phones in the network. You may also need to give the number to Nokia Care services.</p> <p>To view your IMEI number, dial *#06#.</p>

Product and safety information

Network services and costs

You can only use your device on the GSM 850, 900, 1800, 1900 MHz and WCDMA 900, 2100 MHz networks. You need a subscription with a service provider.

Using some features and downloading content require a network connection and may result in data costs. You may also need to subscribe to some features.

Emergency calls

1. Make sure the device is switched on.
2. Check for adequate signal strength.

You may also need to do the following:

- Put a SIM card in the device, if supported by your device.
 - Switch the call restrictions off in your device, such as call barring, fixed dialling, or closed user group.
 - Make sure the flight profile is not activated.
 - If the device keys are locked, unlock them.
3. Press the end key repeatedly, until the home screen is shown.
 4. Type in the official emergency number for your present location. Emergency call numbers vary by location.
 5. Press the call key.
 6. Give the necessary info as accurately as possible. Do not end the call until given permission to do so.

When you switch your device on for the first time, you are asked to create your Nokia account. To make an emergency call during the account setup, press the call key.

- !** **Important:** Activate both cellular and internet calls, if your phone supports internet calls. The phone may attempt to make emergency calls both through cellular networks and through your internet call service provider. Connections in all conditions cannot be guaranteed. Never rely solely on any wireless phone for essential communications like medical emergencies.

Take care of your device

Handle your device, battery, charger and accessories with care. The following suggestions help you keep your device operational.

- Keep the device dry. Precipitation, humidity, and all types of liquids or moisture can contain minerals that corrode electronic circuits. If your device gets wet, remove the battery, and let the device dry.
- Do not use or store the device in dusty or dirty areas.
- Do not store the device in high temperatures. High temperatures may damage the device or battery.
- Do not store the device in cold temperatures. When the device warms to its normal temperature, moisture can form inside the device and damage it.
- Do not open the device other than as instructed in the user guide.
- Unauthorised modifications may damage the device and violate regulations governing radio devices.
- Do not drop, knock, or shake the device. Rough handling can break it.
- Only use a soft, clean, dry cloth to clean the surface of the device.
- Do not paint the device. Paint can prevent proper operation.
- For optimal performance, switch the device off and remove the battery from time to time.
- Keep the device away from magnets or magnetic fields.
- To keep your important data safe, store it in at least two separate places, such as your device, memory card, or computer, or write down important info.

During extended operation, the device may feel warm. In most cases, this is normal. If the device is not working properly, take it to the nearest authorised service facility.

Recycle



Always return your used electronic products, batteries, and packaging materials to dedicated collection points. This way you help prevent uncontrolled waste disposal and promote the recycling of materials. All materials of the device can be recovered as materials and energy. Check how to recycle your Nokia products at www.nokia.com/recycle.

Crossed-out wheeled-bin symbol



The crossed-out wheeled-bin symbol on your product, battery, literature, or packaging reminds you that all electrical and electronic products and batteries must be taken to separate collection at the end of their working life. Do not dispose of these products as unsorted municipal waste: take them for recycling. For info on your nearest recycling point, check with your local waste authority, or go to www.nokia.com/support. For more info on the environmental attributes of your device, see www.nokia.com/ecoprofile.

About Digital Rights Management

When using this device, obey all laws and respect local customs, privacy and legitimate rights of others, including copyrights. Copyright protection may prevent you from copying, modifying, or transferring photos, music, and other content.

Digital rights management (DRM) protected content comes with an associated licence that defines your rights to use the content.

With this device you can access content protected with OMA DRM 2.0. If certain DRM software fails to protect the content, content owners may ask that such DRM software's ability to access new DRM-protected content be revoked. Revocation may also prevent renewal of such DRM-protected content already in your device. Revocation of such DRM software does not affect the use of content protected with other types of DRM or the use of non-DRM-protected content.

Battery and charger info

Use your device only with an original BL-4U rechargeable battery.

Charge your device with AC-20 charger. Charger plug type may vary.

Nokia may make additional battery or charger models available for this device.

Battery and charger safety

Always switch the device off and unplug the charger before removing the battery. To unplug a charger or an accessory, hold and pull the plug, not the cord.

When your charger is not in use, unplug it. If left unused, a fully charged battery will lose its charge over time.

Always keep the battery between 15°C and 25°C (59°F and 77°F) for optimal performance. Extreme temperatures reduce the capacity and lifetime of the battery. A device with a hot or cold battery may not work temporarily.

Accidental short-circuiting can happen when a metallic object touches the metal strips on the battery. This may damage the battery or the other object.

Do not dispose of batteries in a fire as they may explode. Obey local regulations. Recycle when possible. Do not dispose as household waste.

Do not dismantle, cut, crush, bend, puncture, or otherwise damage the battery in any way. If a battery leaks, do not let liquid touch skin or eyes. If this happens, immediately flush the affected areas with water, or seek medical help. Do not modify, attempt to insert foreign objects into the battery, or immerse or expose it to water or other liquids. Batteries may explode if damaged.

Use the battery and charger for their intended purposes only. Improper use, or use of unapproved or incompatible batteries or chargers may present a risk of fire, explosion, or other hazard, and may invalidate any approval or warranty. If you believe the battery or charger is damaged, take it to a service centre before continuing to use it. Never use a damaged battery or charger. Do not charge your device during a lightning storm. Only use the charger indoors.

Additional safety information

Small children

Your device and its accessories are not toys. They may contain small parts. Keep them out of the reach of small children.

Medical devices

Operation of radio transmitting equipment, including wireless phones, may interfere with inadequately shielded medical devices' function. Consult a physician or the medical device's manufacturer to determine if it is adequately shielded from external radio energy.

Implanted medical devices

To avoid potential interference, manufacturers of implanted medical devices recommend a minimum separation of 15.3 centimetres (6 inches) between a wireless device and the medical device. Persons who have such devices should:

- Always keep the wireless device more than 15.3 centimetres (6 inches) from the medical device.
- Not carry the wireless device in a breast pocket.
- Hold the wireless device to the ear opposite the medical device.
- Switch the wireless device off if there is any reason to suspect that interference is taking place.
- Follow the manufacturer directions for the implanted medical device.

If you have any questions about using your wireless device with an implanted medical device, consult your health care provider.

Hearing



Warning: When you use the headset, your ability to hear outside sounds may be affected. Do not use the headset where it can endanger your safety.

Some wireless devices may interfere with some hearing aids.

Nickel

The surface of this device is nickel-free.

Protect your device from harmful content

Your device may be exposed to viruses and other harmful content. Take the following precautions:

- Be cautious when opening messages. They may contain malicious software or otherwise be harmful to your device or computer.
- Be cautious when accepting connectivity requests, browsing the internet, or downloading content. Do not accept Bluetooth connections from sources you do not trust.
- Only install and use services and software from sources that you trust and that offer adequate security and protection.
- Install antivirus and other security software on your device and any connected computer. Only use one antivirus app at a time. Using more may affect performance and operation of the device and/or computer.
- If you access preinstalled bookmarks and links to third party internet sites, take the appropriate precautions. Nokia does not endorse or assume liability for such sites.

Vehicles

Radio signals may affect improperly installed or inadequately shielded electronic systems in vehicles. For more info, check with the manufacturer of your vehicle or its equipment.

Only qualified personnel should install the device in a vehicle. Faulty installation may be dangerous and invalidate your warranty. Check regularly that all wireless device equipment in your vehicle is mounted and operating properly. Do not store or carry flammable or explosive materials in the same compartment as the device, its parts, or accessories. Do not place your device or accessories in the air bag deployment area.

Potentially explosive environments

Switch your device off in potentially explosive environments, such as near petrol pumps. Sparks may cause an explosion or fire resulting in injury or death. Note restrictions in areas with fuel; chemical plants; or where blasting operations are in progress. Areas with a potentially explosive environment may not be clearly marked. These usually are areas where you are advised to switch your engine off, below deck on boats, chemical transfer or storage facilities, and where the air contains chemicals or particles. Check with the manufacturers of vehicles using liquefied petroleum gas (such as propane or butane) if this device can be safely used in their vicinity.

Certification information (SAR)

This mobile device meets international guidelines for exposure to radio waves.

Your mobile device is a radio transmitter and receiver. It is designed not to exceed the limits for exposure to radio waves (radio frequency electromagnetic fields), recommended by international guidelines from the independent scientific organization ICNIRP. These guidelines incorporate substantial safety margins assure the protection of all persons regardless of age and health.

The exposure guidelines are based on the Specific Absorption Rate (SAR), which is an expression of the amount of radio frequency (RF) power deposited in the head or body when the device is transmitting. The ICNIRP SAR limit for mobile devices is 2.0 W/kg averaged over 10 grams of tissue.

SAR tests are carried out with the device in standard operating positions, transmitting at its highest certified power level, in all its frequency bands. The maximum recorded SAR values for this device are:

	Maximum SAR value	Frequency bands used when Maximum SAR value was recorded
When held against the head	1.15 W/kg over 10g	WCDMA 2100
When operated at a separation distance of 1.5 centimetres (5/8 inch) from the body	1.14 W/kg over 10g	WCDMA 2100

This device meets RF exposure guidelines when used against the head or when positioned at least 1.5 centimetres (5/8 inch) away from the body. When a carry case, belt clip or other form of device holder is used for body-worn operation, it should not contain metal and should provide at least the above stated separation distance from the body.

To send data or messages, a good connection to the network is needed. Sending may be delayed until such a connection is available. Follow the separation distance instructions until the sending is finished.

During general use, the SAR values are usually well below the values stated above. This is because, for purposes of system efficiency and to minimise interference on the network, the operating power of your mobile is automatically decreased when full power is not needed for the call. The lower the power output, the lower the SAR value.

Device models may have different versions and more than one value. Component and design changes may occur over time and some changes could affect SAR values. The latest available SAR information for this and other Nokia device models can be found at www.nokia.com.

The World Health Organization (WHO) has stated that current scientific information does not indicate the need for any special precautions when using mobile devices. If you are interested in reducing your exposure, they recommend you limit your usage or use a hands-free kit to keep the device away from your head and body. For more information and explanations and discussions on RF exposure, go to the WHO website at www.who.int/peh-emf/en.

Nokia support messages

To help you take maximum advantage of your phone and services, you receive free customised text messages from Nokia. The messages contain tips and tricks and support.

To stop receiving the messages, select **Menu > Settings > Nokia account > News and Offers**.

To provide the service described above, your mobile phone number, the serial number of your phone, and some identifiers of the mobile subscription are sent to Nokia when you use the phone for the first time. Some or all information may also be sent to Nokia when updating software. This information may be used as specified in the privacy policy, available at www.nokia.com.

Copyrights and other notices

DECLARATION OF CONFORMITY

CE 0168

Hereby, NOKIA CORPORATION declares that this RM-952 product is in compliance with the essential requirements and other relevant provisions of Directive 1999/5/EC. A copy of the Declaration of Conformity can be found at www.nokia.com/global/declaration/declaration-of-conformity.

The availability of products, features, apps and services may vary by region. For more info, contact your Nokia dealer or your service provider. This device may contain commodities, technology or software subject to export laws and regulations from the US and other countries. Diversion contrary to law is prohibited.

The contents of this document are provided "as is". Except as required by applicable law, no warranties of any kind, either express or implied, including, but not limited to, the implied warranties of merchantability and fitness for a particular purpose, are made in relation to the accuracy, reliability or contents of this document. Nokia reserves the right to revise this document or withdraw it at any time without prior notice.

To the maximum extent permitted by applicable law, under no circumstances shall Nokia or any of its licensors be responsible for any loss of data or income or any special, incidental, consequential or indirect damages howsoever caused.

Reproduction, transfer or distribution of part or all of the contents in this document in any form without the prior written permission of Nokia is prohibited. Nokia operates a policy of continuous development. Nokia reserves the right to make changes and improvements to any of the products described in this document without prior notice.

Reverse engineering of software in the device is prohibited to the extent permitted by applicable law. Insofar as this user guide contains any limitations on Nokia's representations, warranties, damages and liabilities, such limitations shall likewise limit any representations, warranties, damages and liabilities of Nokia's licensors.

Nokia does not provide a warranty for or take any responsibility for the functionality, content, or end-user support of third-party apps provided with your device. By using an app, you acknowledge that the app is provided as is. Nokia does not make any representations, provide a warranty, or take any responsibility for the functionality, content, or end-user support of third-party apps provided with your device.

Downloading of maps, games, music and videos and uploading of images and videos may involve transferring large amounts of data. Your service provider may charge for the data transmission. The availability of particular products, services and features may vary by region. Please check with your local Nokia dealer for further details and availability of language options.

FCC NOTICE

This device complies with part 15 of the FCC rules. Operation is subject to the following two conditions: (1) This device may not cause harmful interference, and (2) this device must accept any interference received, including interference that may cause undesired operation. Any changes or modifications not expressly approved by Nokia could void the user's authority to operate this equipment.

Note: This equipment has been tested and found to comply with the limits for a Class B digital device, pursuant to part 15 of the FCC Rules. These limits are designed to provide reasonable protection against harmful interference in a residential installation. This equipment generates, uses and can radiate radio frequency energy and, if not installed and used in accordance with the instructions, may cause harmful interference to radio communications. However, there is no guarantee that interference will not occur in a particular installation. If this equipment does cause harmful interference to radio or television reception, which can be determined by turning the equipment off and on, the user is encouraged to try to correct the interference by one or more of the following measures:

- Reorient or relocate the receiving antenna.
- Increase the separation between the equipment and receiver.
- Connect the equipment into an outlet on a circuit different from that to which the receiver is connected.
- Consult the dealer or an experienced radio/TV technician for help.

TM & © 2013 Nokia. All rights reserved. Third party products/names may be TMs of their respective owners.

The Bluetooth word mark and logos are owned by the Bluetooth SIG, Inc. and any use of such marks by Nokia is under license.



Java and all Java-based marks are trademarks or registered trademarks of Sun Microsystems, Inc.

This product is licensed under the MPEG-4 Visual Patent Portfolio License (i) for personal and noncommercial use in connection with information which has been encoded in compliance with the MPEG-4 Visual Standard by a consumer engaged in a personal and noncommercial activity and (ii) for use in connection with MPEG-4 video provided by a licensed video provider. No license is granted or shall be implied for any other use. Additional information, including that related to promotional, internal, and commercial uses, may be obtained from MPEG LA, LLC. See www.mpegla.com.